

SAFETY FEATURES

- Electronic and mechanical door interlocks on elevator cars and ground enclosure unit
- Overload device to prevent elevator operation when rated payload has been exceeded
- Spring buffer assembly
- Low and medium speed elevators do not require counterweights
- Galvanized tower sections and tie-ins

DESIGN FEATURES

- Smooth starting and stopping without surging or jarring the elevator car
- The lifting speed can be easily controlled and is infinitely variable
- The elevator starting current is lower than the rated current
- Using the frequency conversion drive greatly reduces mechanical wear and tear on the elevator and its components
- The frequency conversion drive is more efficient and uses less power.

INSTALLATION

- For instructions regarding the erection, climbing, dismantling, operation and maintenance of the elevator car refer to the operations manual.
- This product must be operated by competent, orientated personnel and used in a safe manner to conform with the manufacturers specifications and in compliance with all federal, state standards and regulations.
- Drawings are for illustrative purposes only and do not necessarily show the exact configurations of products offered on the market at a particular time.

IN PURSUIT OF EXCELLENCE

SUN CRANE AND HOIST, INC; we believe that our business is not equipment but service as well. Because of this belief, **SUN CRANE AND HOIST, INC;** offers service for all rigging, mechanical, electrical and engineering needs. We make it our business to ensure that the services we offer are by far superior to any of our competitors because we understand that your projects are only as good as the equipment used to build it.

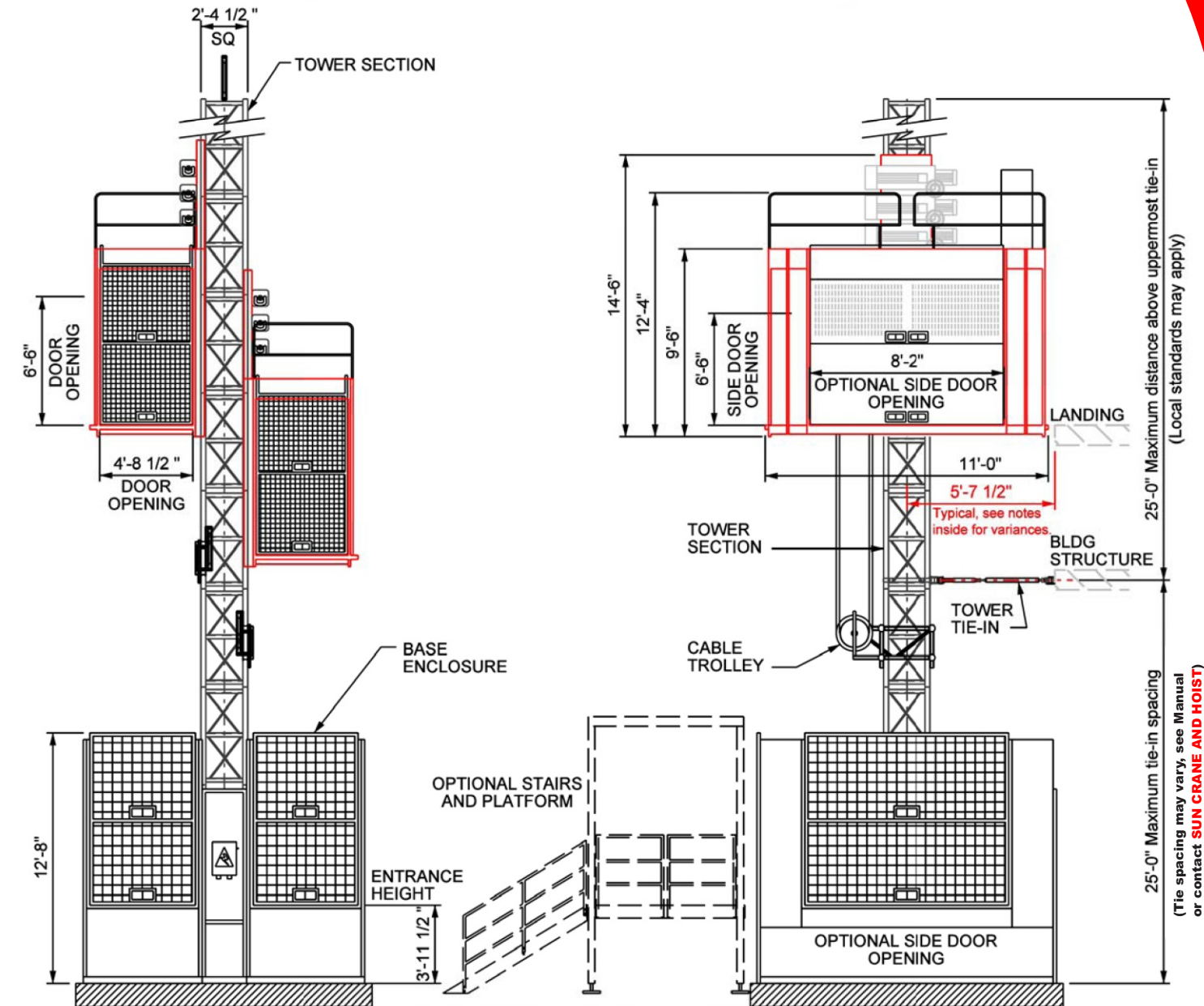
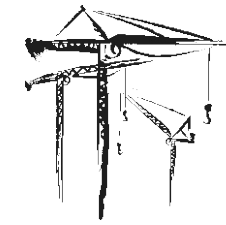

SUN CRANE AND HOIST, INC.

2214 HWY 1187 Build#1

MANSFIELD, TEXAS 76063

OFFICE: 817.225.1090 * FAX: 817.225.1035

WWW.SUNCRANEANDHOIST.COM



TIE-IN DETAILS

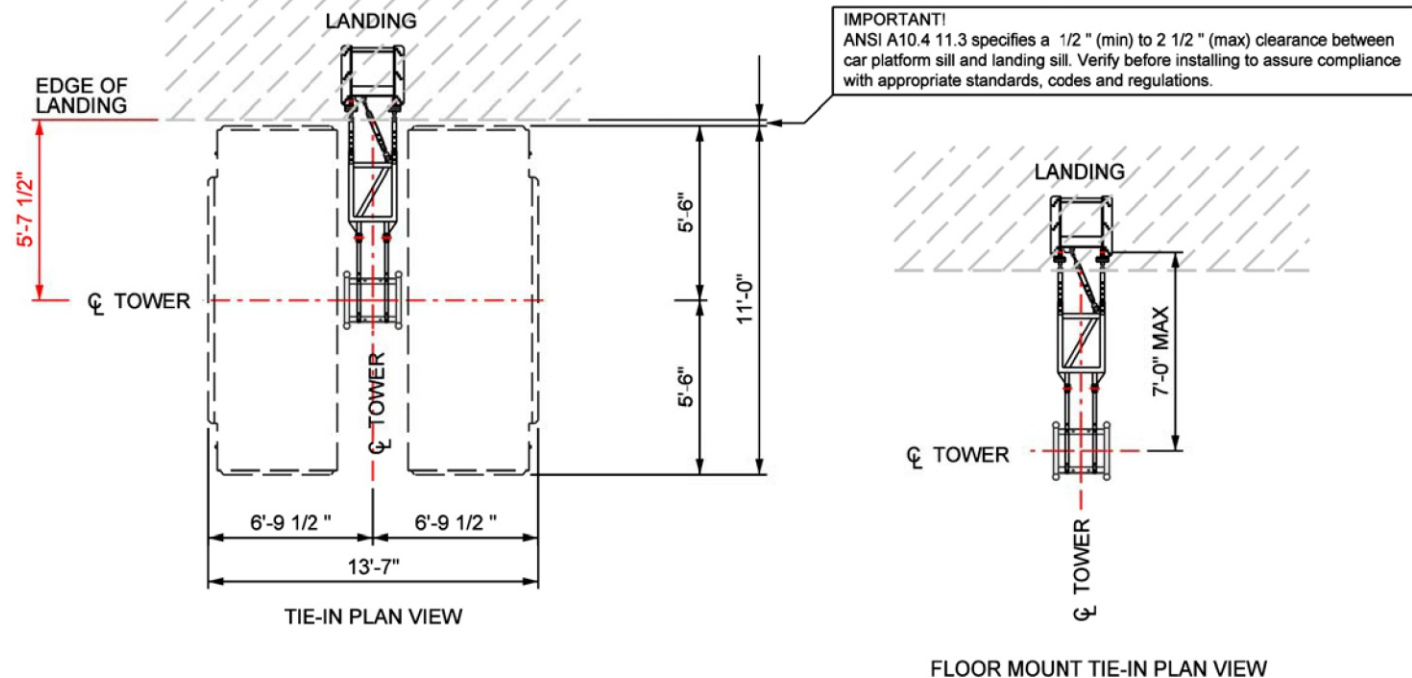

NOTE:
Distance above are for a typical 5 tir-in. Alternate anchoring methods are available. Contact **SUN CRANE AND HOIST, Inc.** for more information.

MODEL VARIATIONS

F 5000 DLS

150 FPM (LOW SPEED)

GENERAL

LOAD CAPACITY	5,000 lb (PER CAR)
INSIDE ELEVATOR CAR DIMENSIONS	4'-10" wide x 7'-9" high x 10'-9" long
DOOR OPENING (END)	4'-8 1/2" x 6'-6"
OPTIONAL SIDE DOOR OPENING	8'-2" x 6'-6"
TOWER SECTION LENGTH	4'-11 1/2"
MAXIMUM TOWER HEIGHT	490'-0" (For greater heights please consult SUN CRANE AND HOIST, INC.)
MAXIMUM TOWER TIE-IN SPACING	25'-0"

WEIGHTS

GROUND ENCLOSURE	1,980 lb
BASE UNIT	1,200 lb
ELEVATOR CAR	7,880 lb
TOWER SECTION (8 mm)	510 lb
TIE-IN (TYPE 5)	212 lb per set

ELECTRICAL

POWER REQUIREMENT (PER CAR)	480 VOLT - 150 AMPS - 3 PHASE - 60 HZ
MOTORS (PER CAR)	3 x 30 HP



F5000-DLS FOUNDATION DETAILS

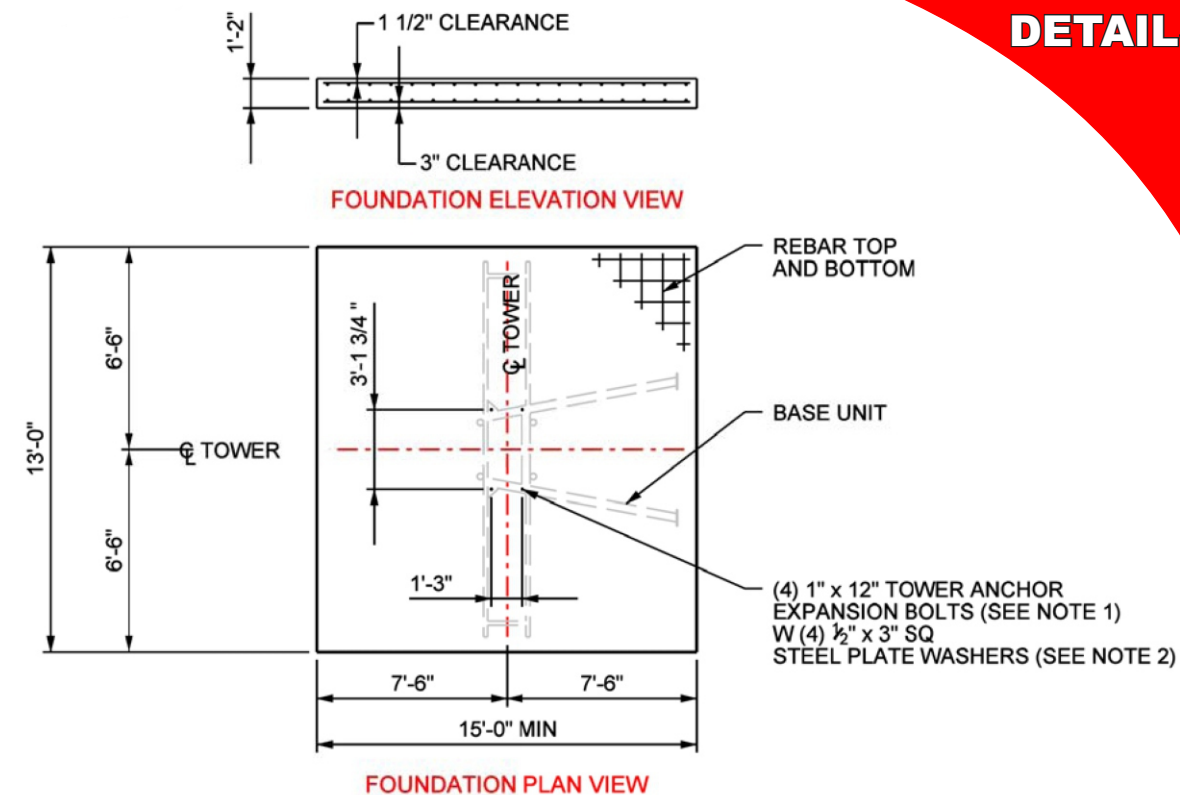

NOTES:

- 1" x 12" HILTI Kwik Bolt II anchor bolt or approved equal. Bolt by contractor. Install according to bolt manufacturer's requirements.
- Foundation slab: 13'-0" x 15'-0" x 1'-2" with 3,500 psi concrete.
- Reinforcing bars are #5 ASTM 615-60 10" o.c. each way.
- Foundation based on 490 foot mast height. For greater heights contact SUN CRANE AND HOIST for design.
- Foundation pad designed for a minimum soil bearing of 1,000 psf.
- Refer to manufacturers manual before installing, operating, servicing, repairing, jumping or dismantling.

